

Spider Bolt

Portable, reusable anchorage connectors designed for use in concrete applications

- A safe anchor point is established when the Spider Bolt anchor is inserted into a properly-sized, cured concrete hole.
- The reusable Spider Bolt anchor can be removed and simply reinstalled in a new location.
- Designed for vertical or overhead/ceiling surface applications
- Constructed of stainless steel, aluminum and other non-corrosive materials for a longer service life
- Designed for use in cured concrete with a compression strength of at least 3,000 psi
- Color-coded to differentiate fall protection from multi-use models per OSHA regulations

Fall Protection Anchorage Connectors

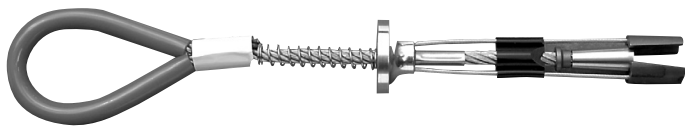

BD-00009

Designed for single user fall protection applications. A safe 5,000 lb. (2,268 kg) anchor point is established by drilling a 3/4 in. (19 mm) diameter hole in cured concrete and inserting the Spider Bolt anchor. The maximum capacity is 400 lb (181.4 kg). A variety of connecting devices, including a shock-absorbing lanyard or self-retracting lifeline, can be attached to the Spider Bolt. (This unit is color-coded green to indicate fall protection use only.)

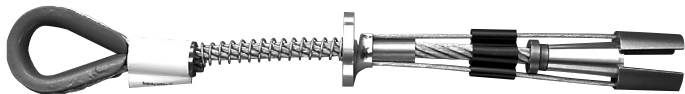

BD-00018

Designed for single user fall protection applications or as anchorage connectors for a dual user temporary horizontal lifeline system. A safe 10,000 lb. (4,535.9 kg) anchor point is established by drilling a 1 in. (25 mm) diameter hole in cured concrete and inserting the Spider Bolt anchor. The maximum capacity is 400 lb (181.4 kg). (This unit is color-coded green to indicate fall protection use only.)

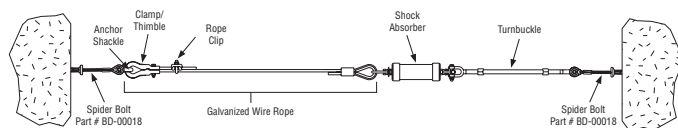

BD-00018-HLL Temporary Horizontal Lifeline Kit

Provides a temporary horizontal lifeline system that is quick and easy to install and accommodates two workers. Kit includes 60 ft (18.3 m) of galvanized wire rope lifeline, turnbuckle, shock absorber, combination clamp and thimble, wire rope clip, anchor shackle and two model BD-00018 Spider Bolt anchorage connectors.